

Ford Kuga II 03/2013 >> 01/2020

Partnr.: FR-066-D1U

- Fitting instructions electric wiring kit tow bar with 13-P socket up to DIN/ISO Norm 11446.
- We would expressly point out that assembly not carried out properly by a competent installer will result in cancellation of any right to damage compensation, in particular those arising by virtue of the product liability act.
- Contents of these kits and their fitting manuals are subject to alteration without notice, please ensure that these instructions are read and fully understood before commencing installation.
- Do not overload circuits; the maximum loads per connection are detailed in this manual.
- Attention! Before Installation, please read this manual carefully and inform your customer to consult the vehicle owners manual to check for any vehicle modifications required before towing.
- In the event of functional problems, troubleshooting must be limited to about 0.5 hours, contact the technical support:
ukts@ecs-electronics.com / 07440 202 052.



Part list

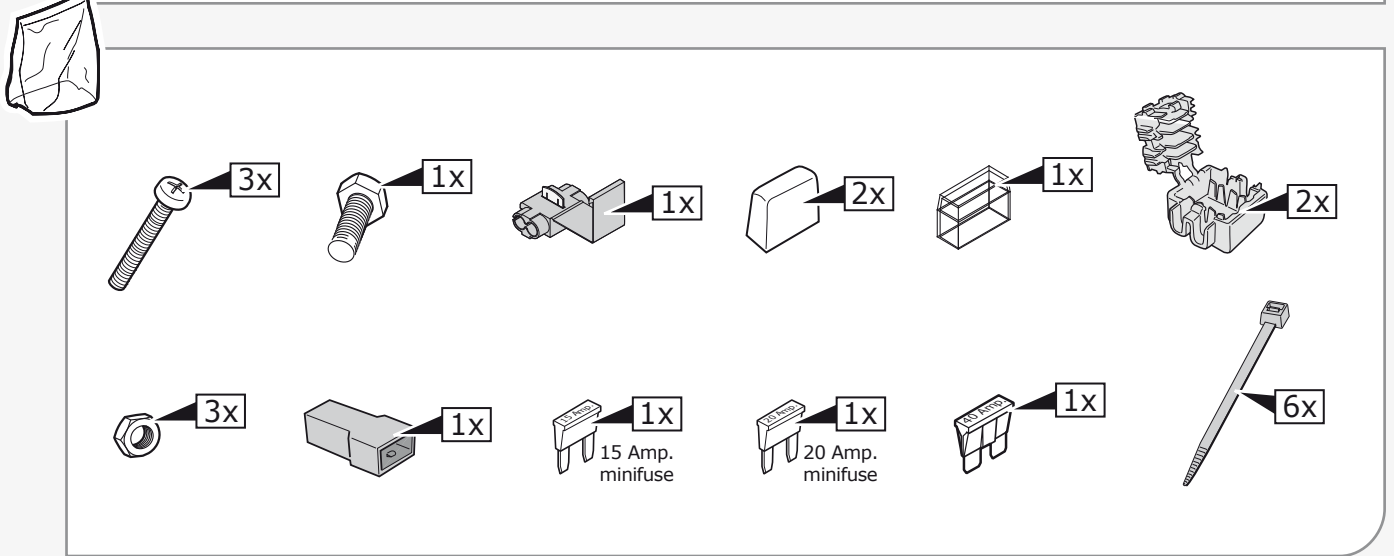
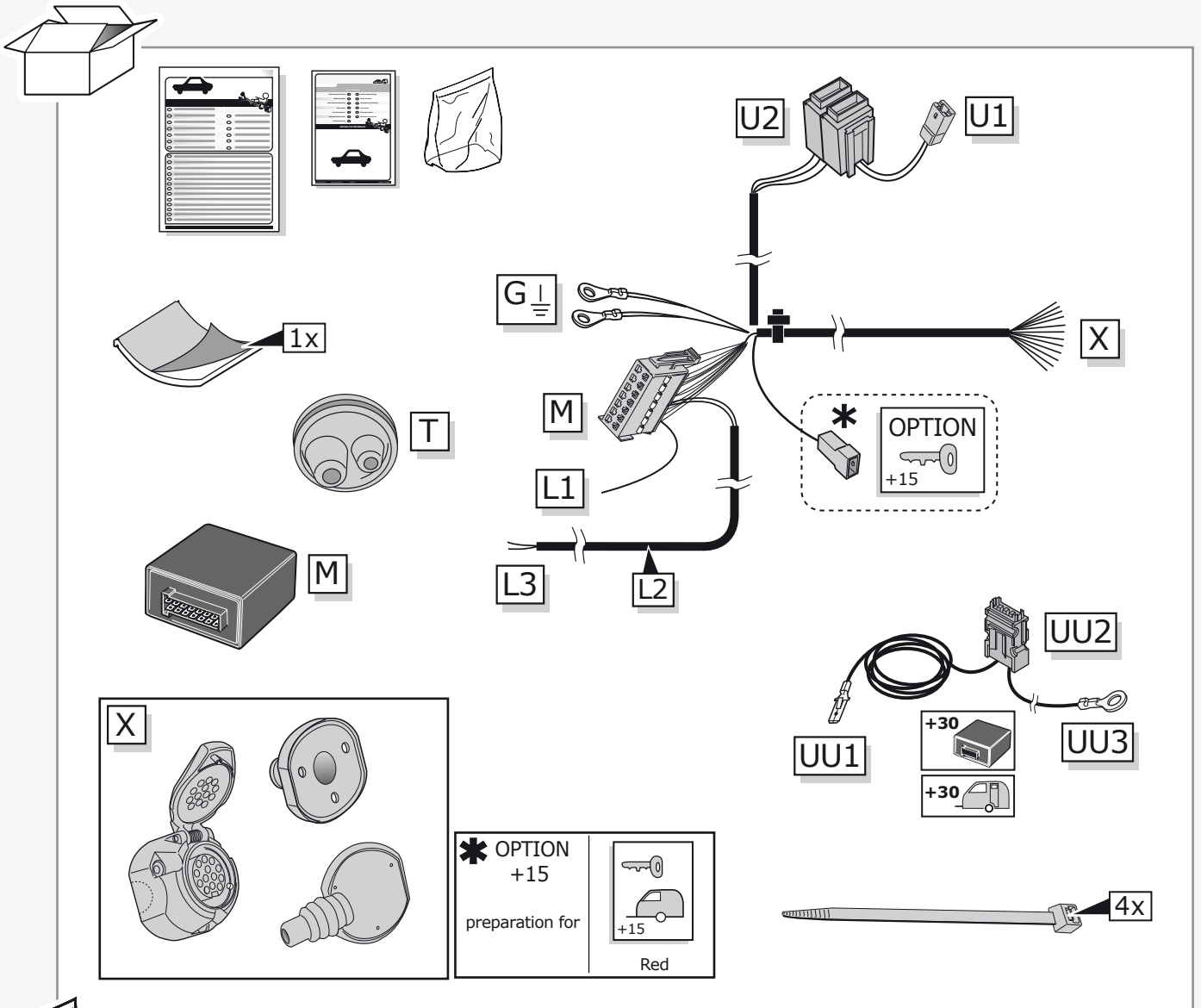

TOOLS

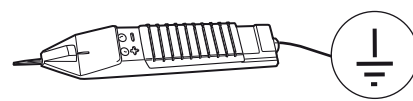
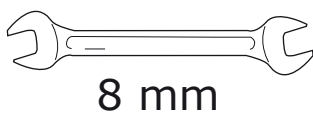
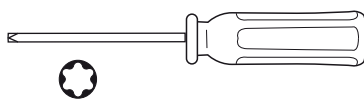
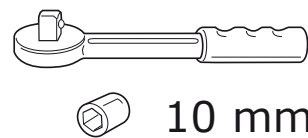
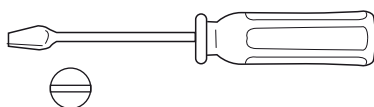
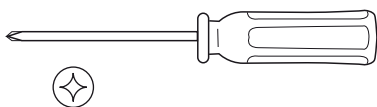

ROUTING

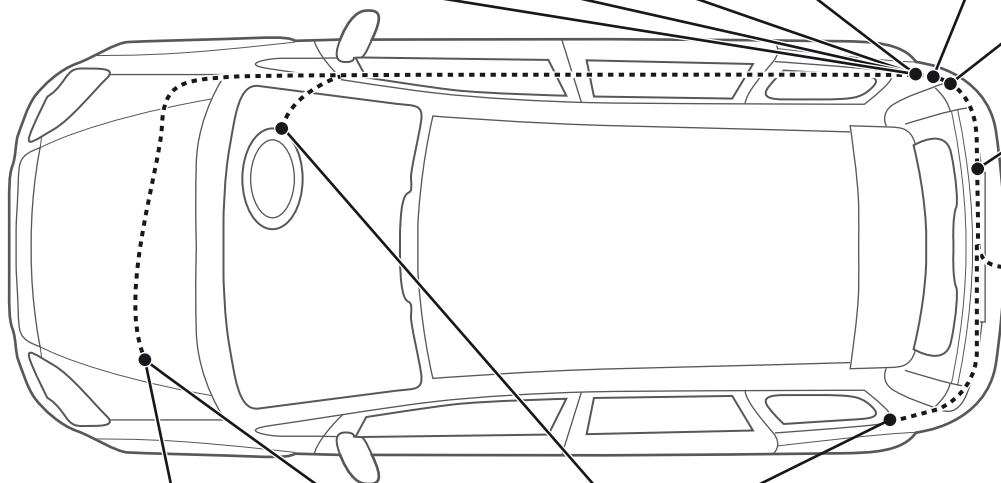
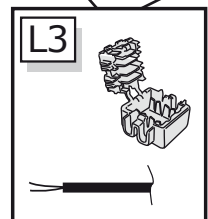
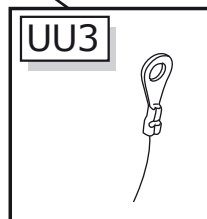
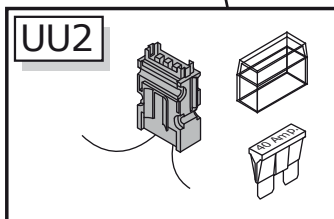
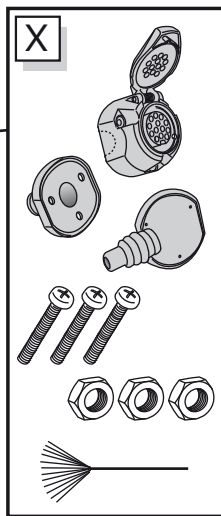
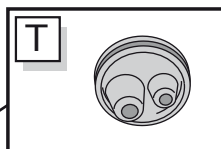
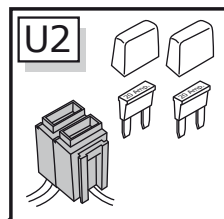
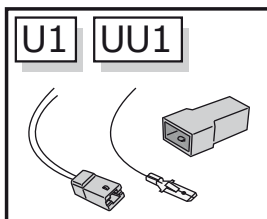
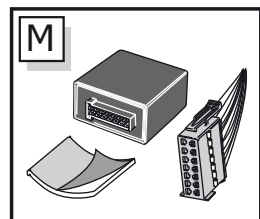
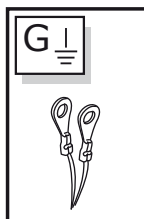
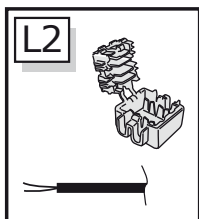
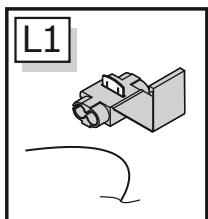

1

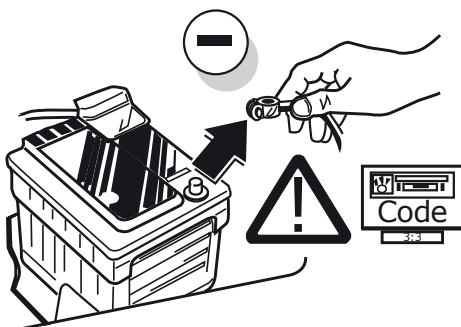

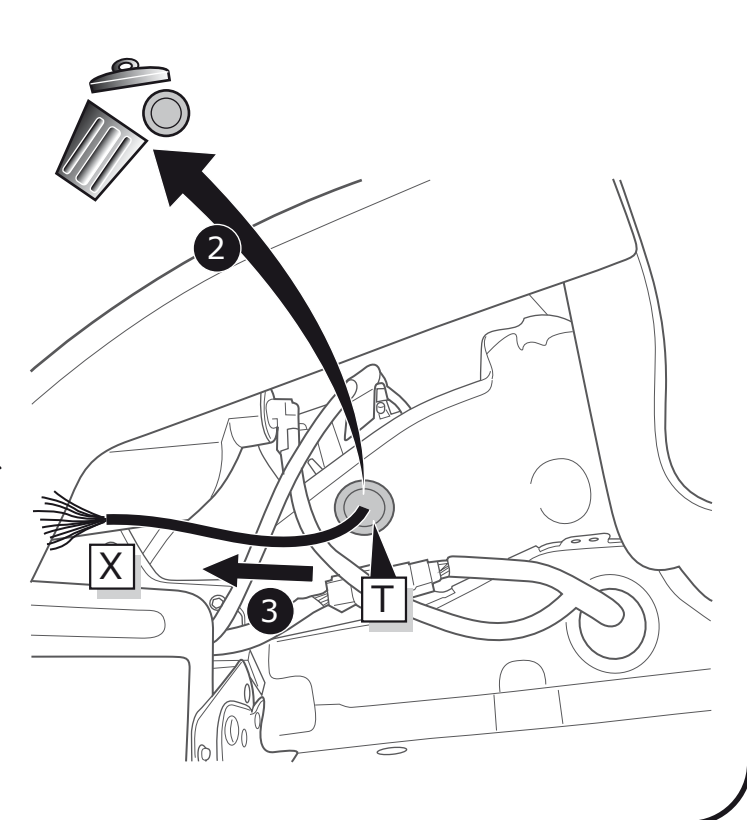
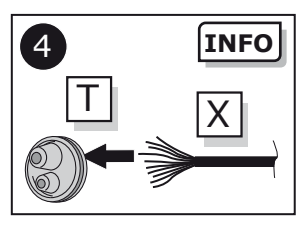
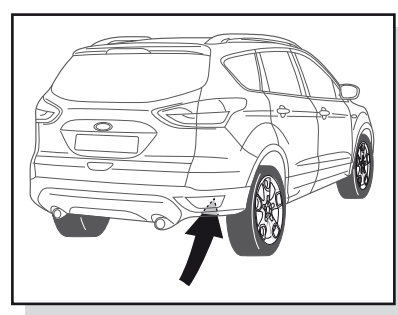
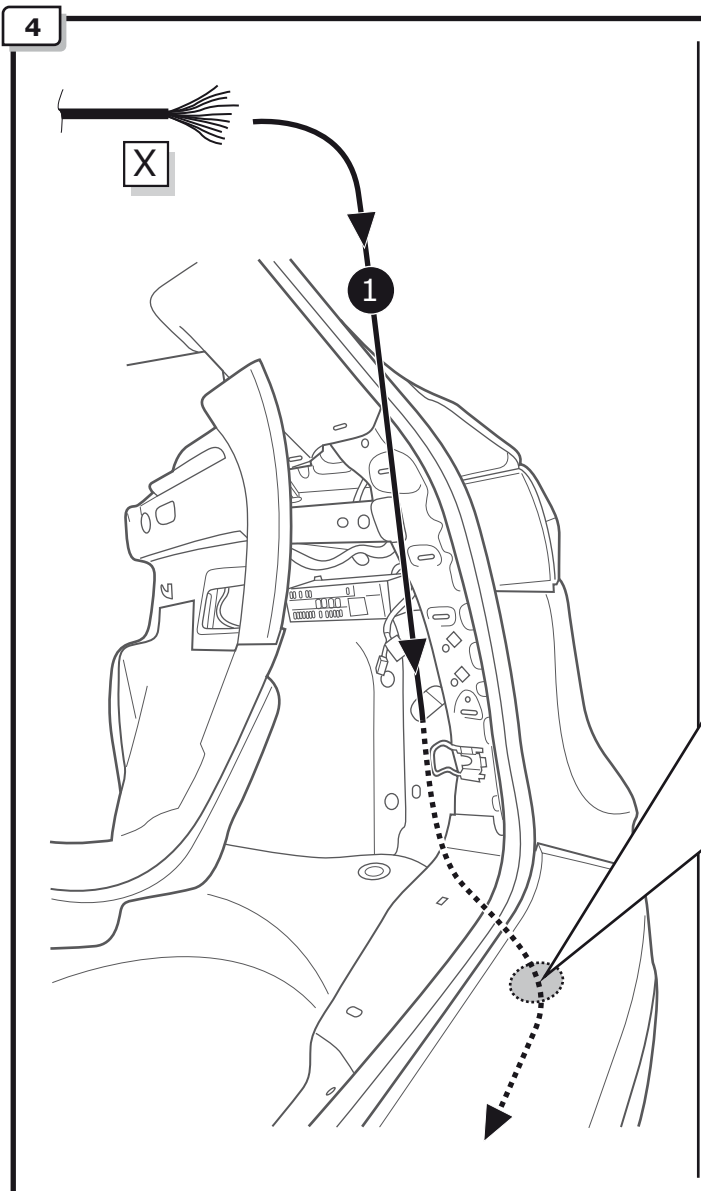
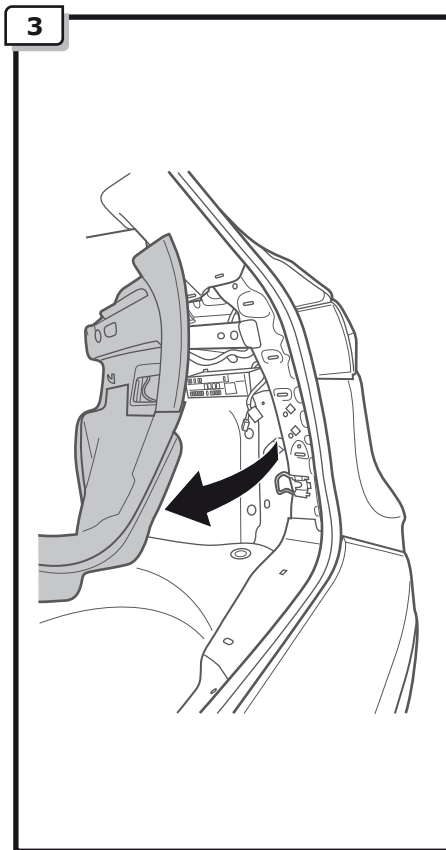
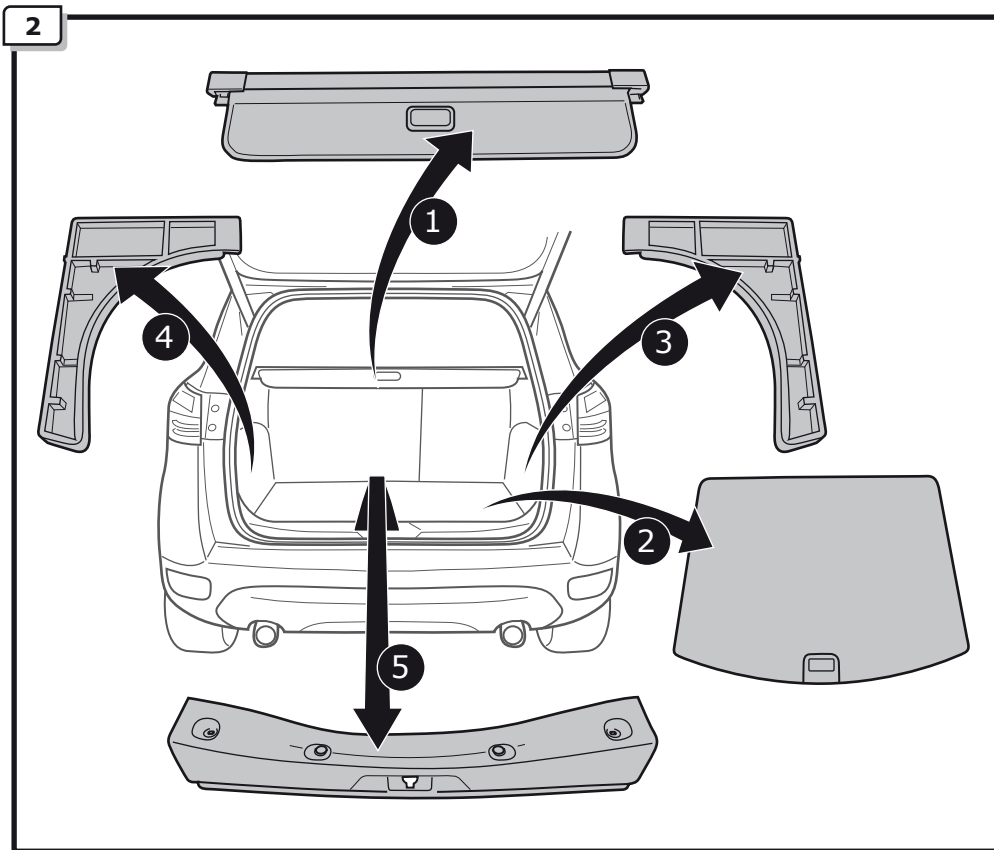

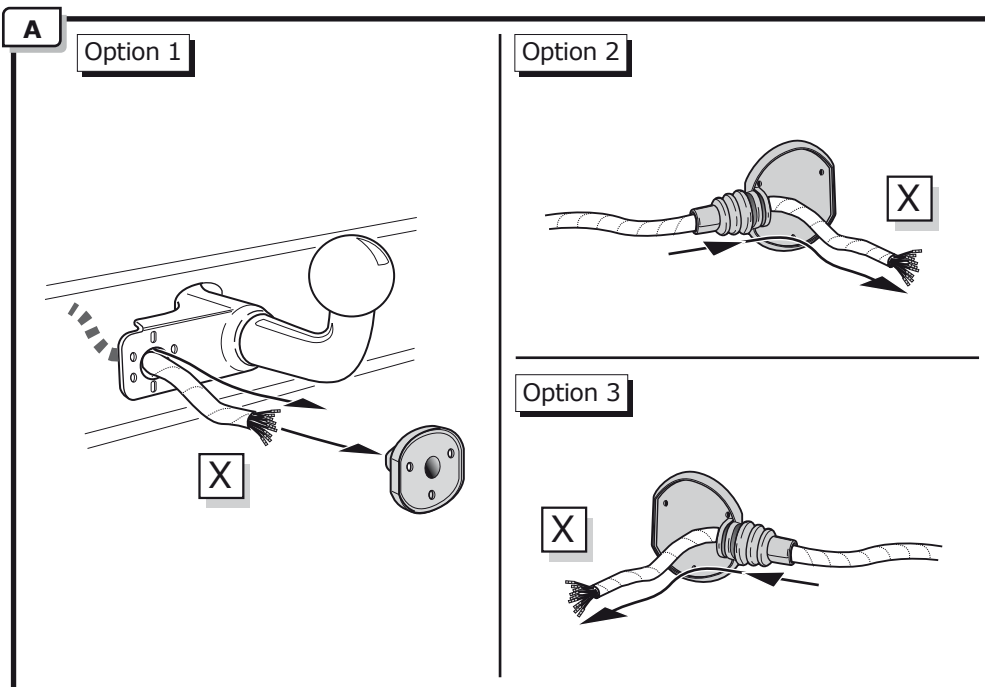

INFO

SOCKET CONNECTION

Page 15

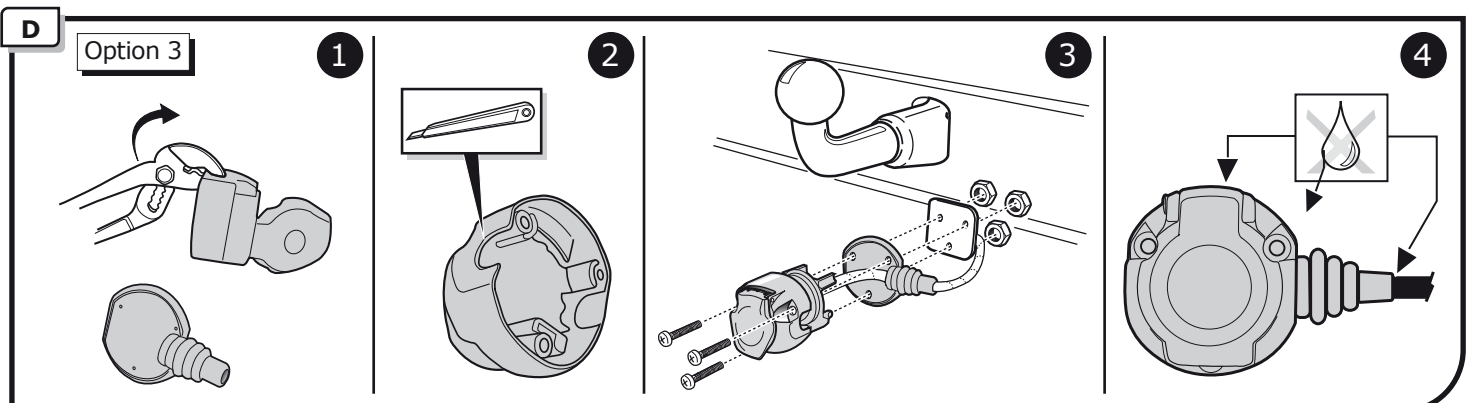
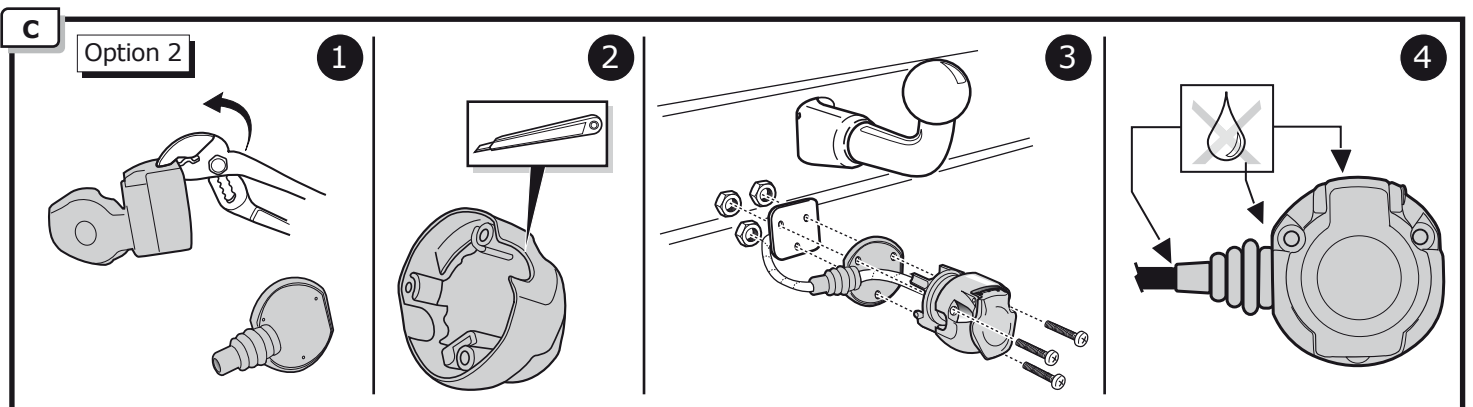
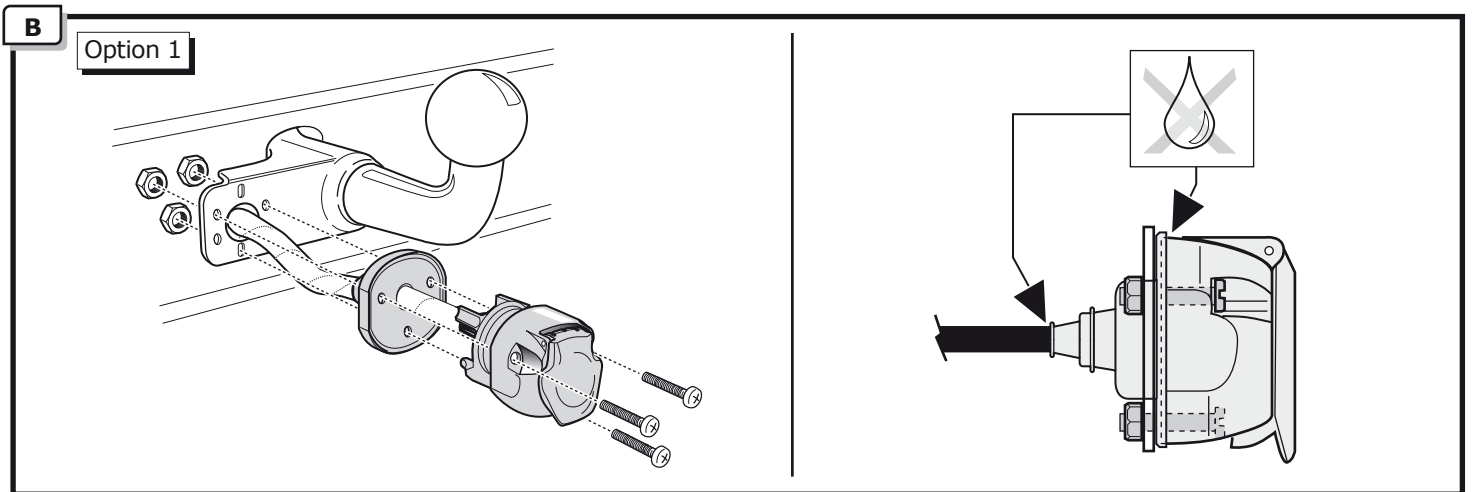

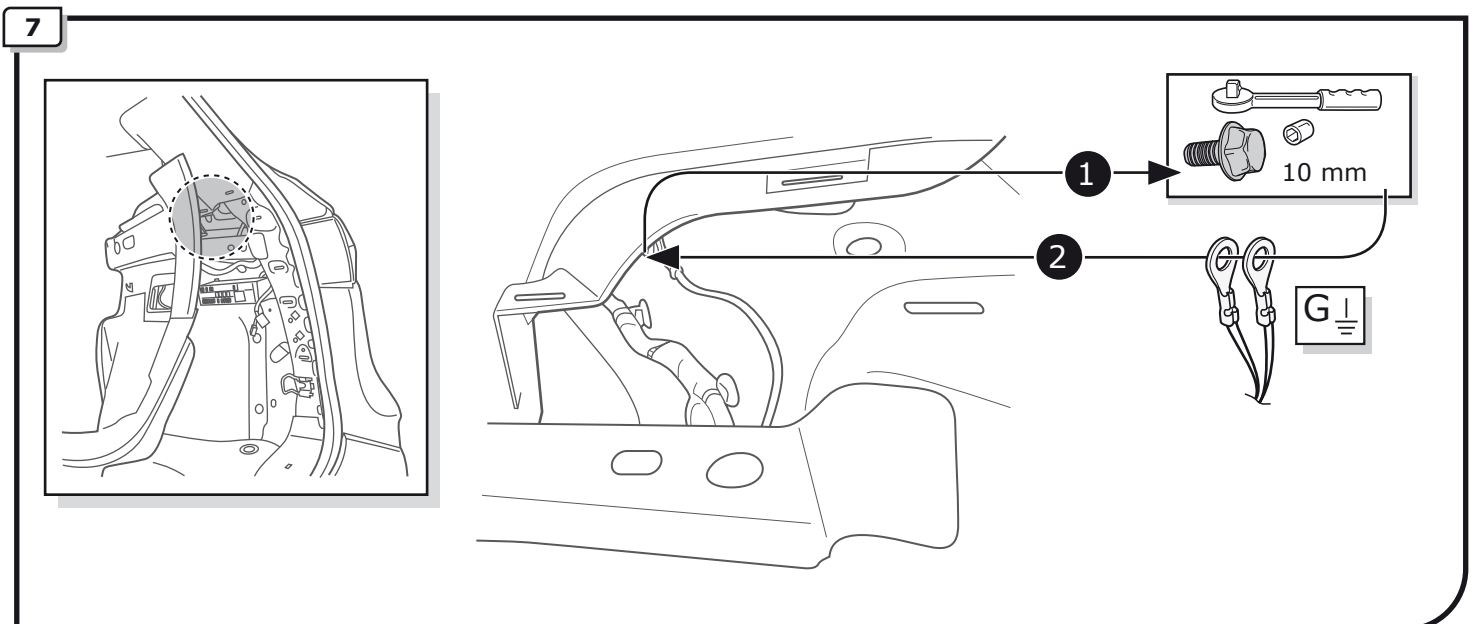
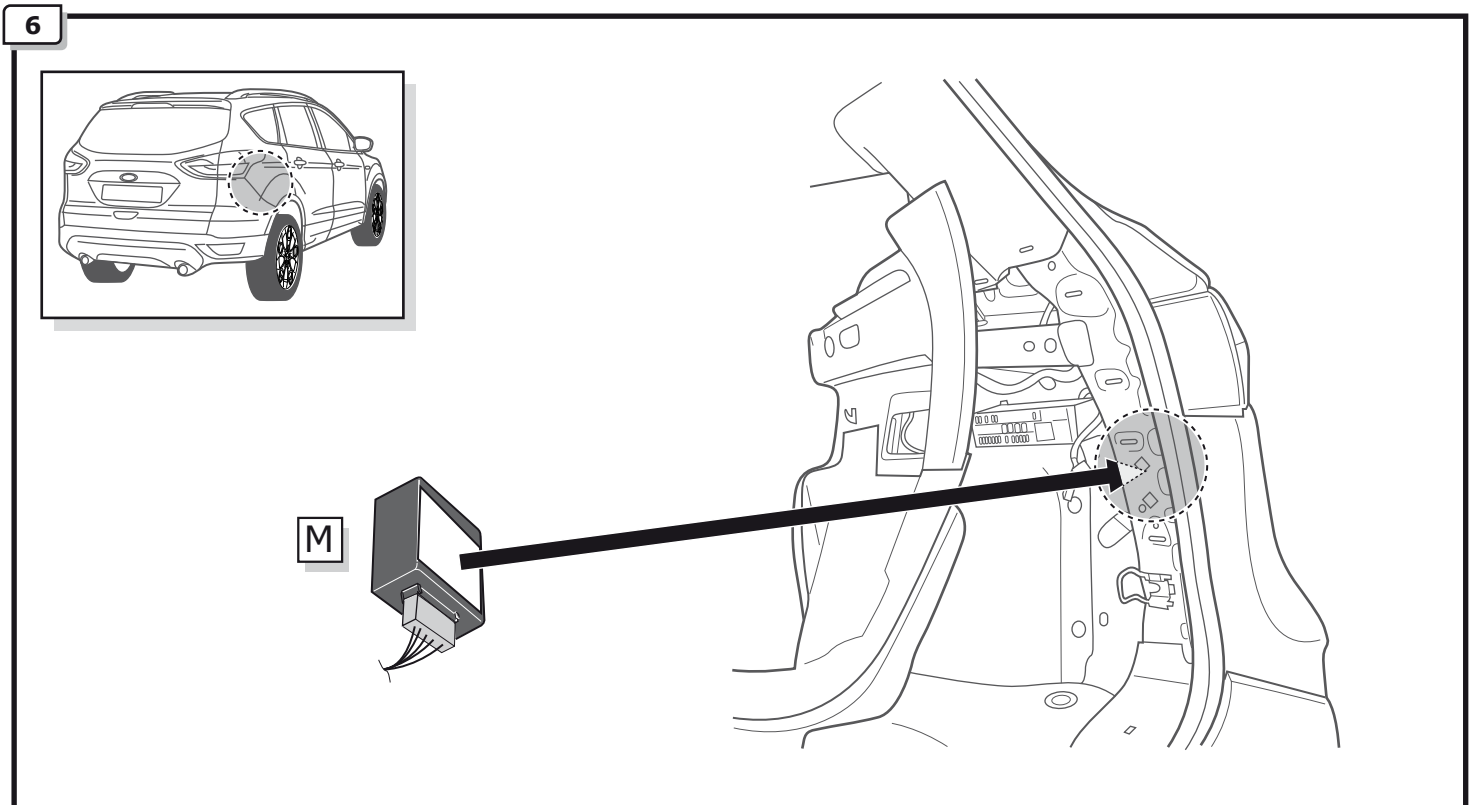
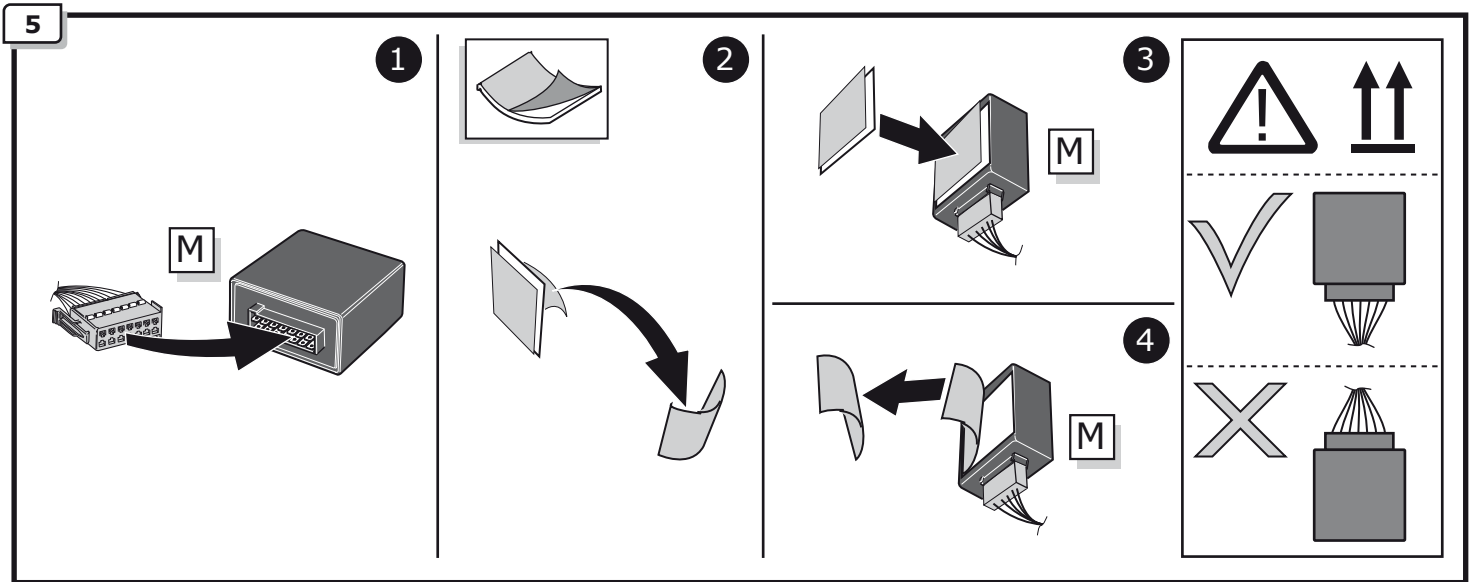

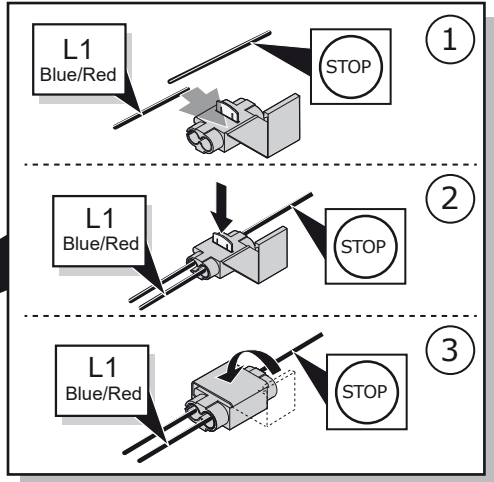
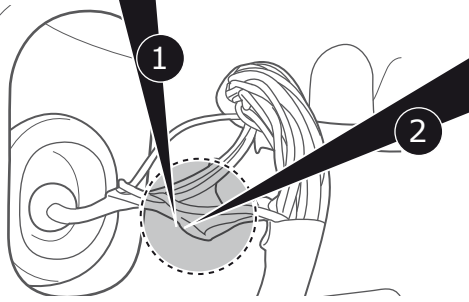
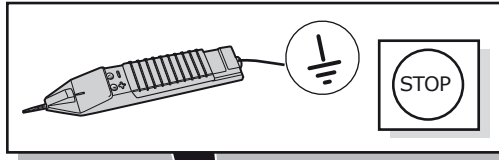
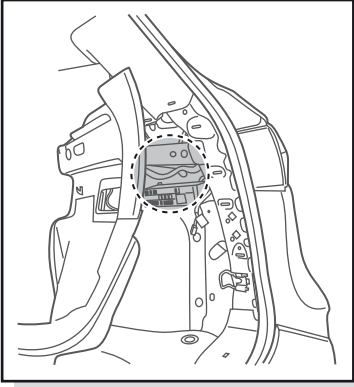

INFO

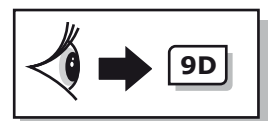
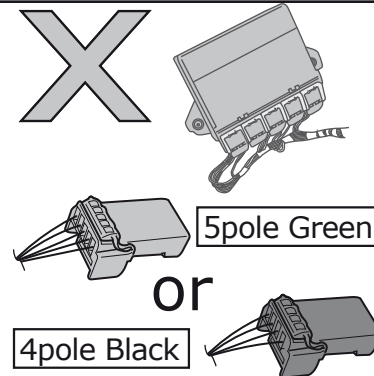
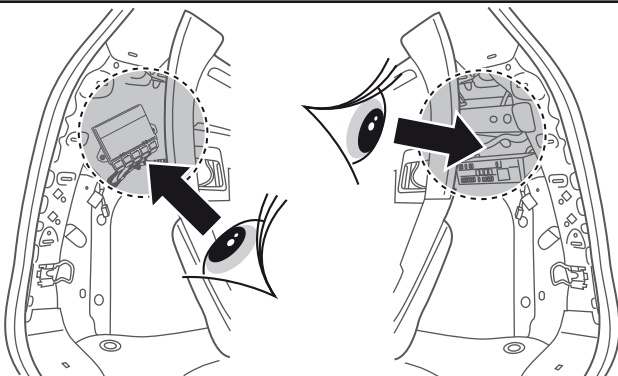
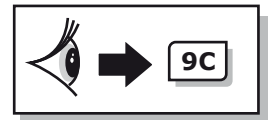
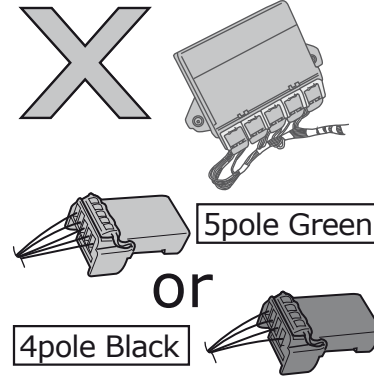
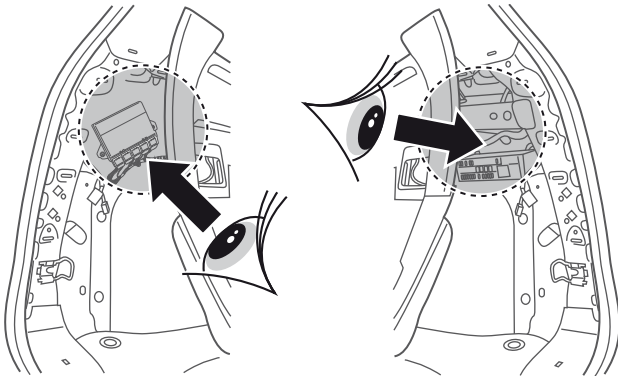
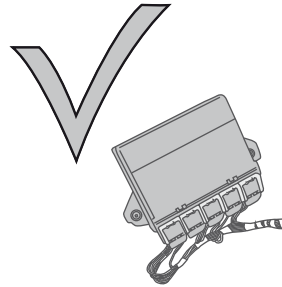
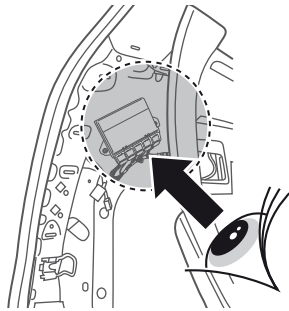
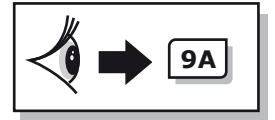
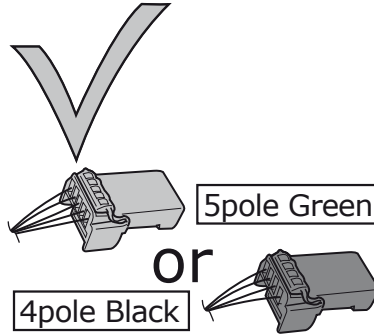
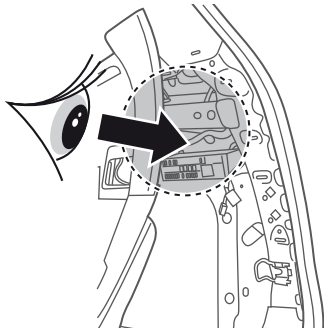

9A

OPTION 1

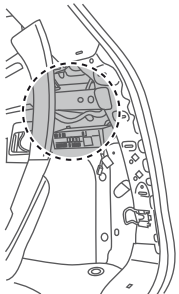
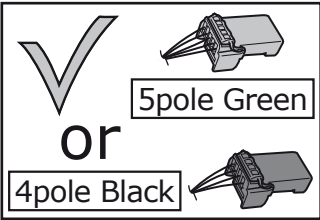
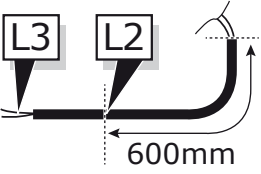

1

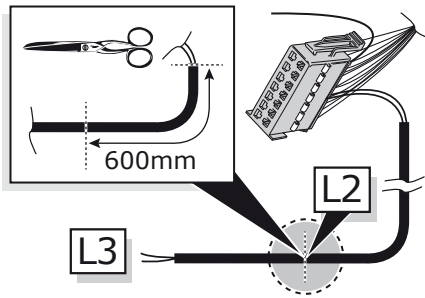

2

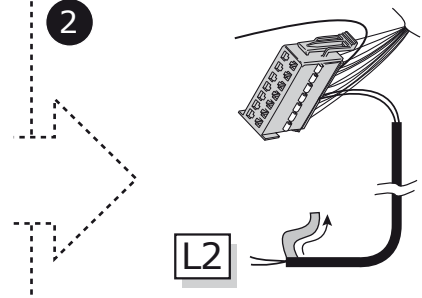

3

4pole Black

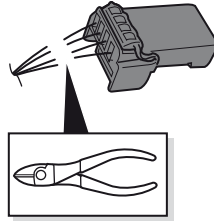

5pole Green

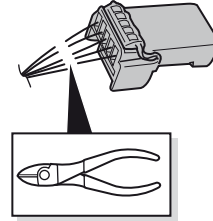

or

4

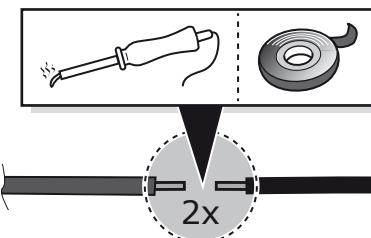

9B

OPTION 2

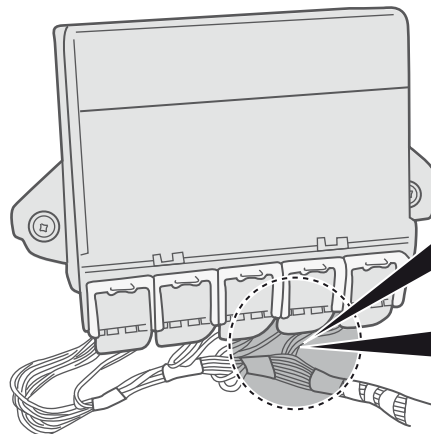
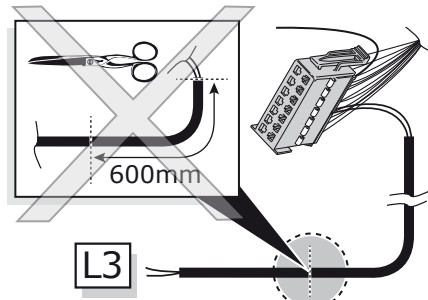
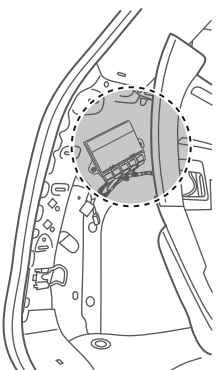
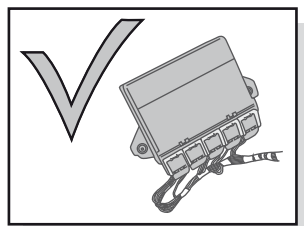

3

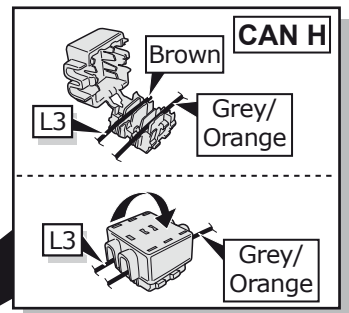

4

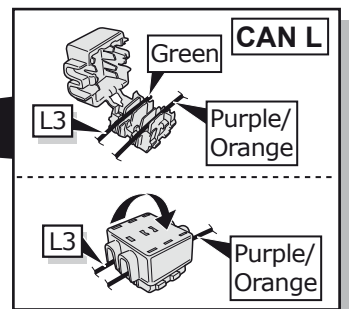

OPTION 3

L3

X

5pole Green

4pole Black

or

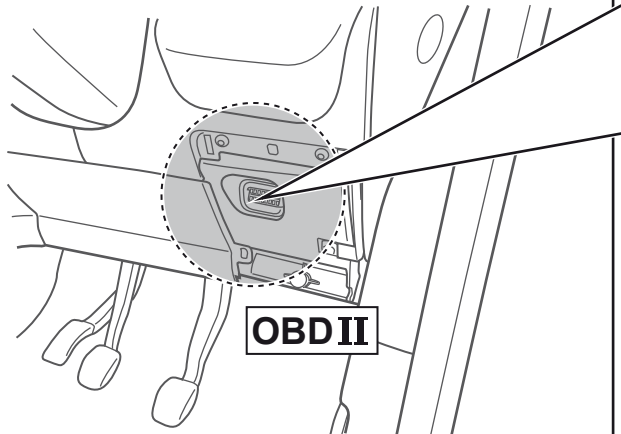
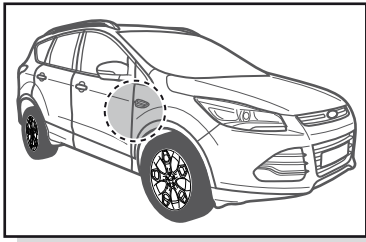
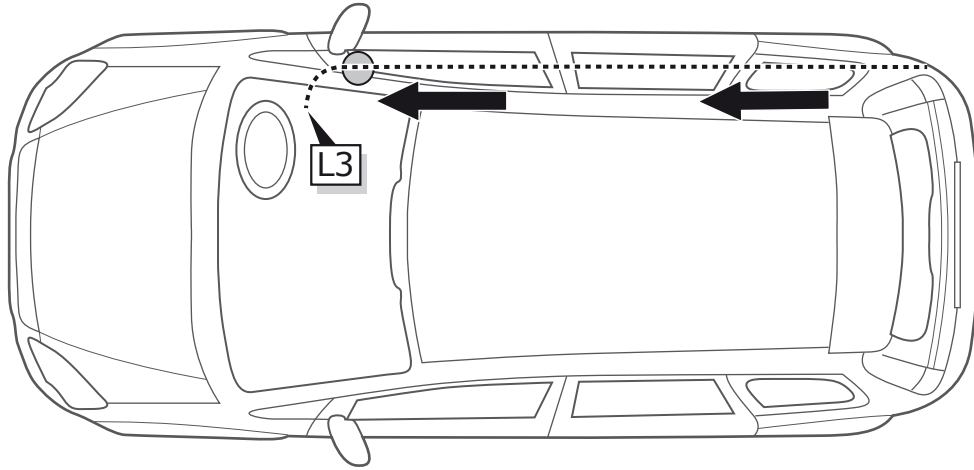
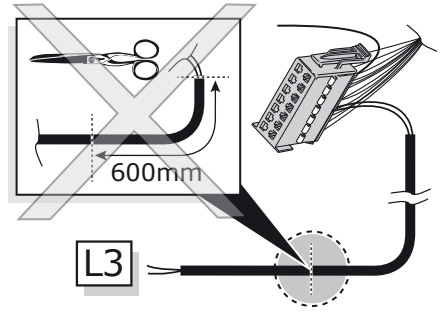

CAN H

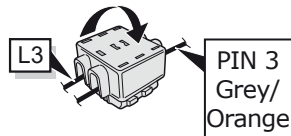
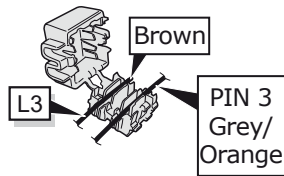

2

CAN L

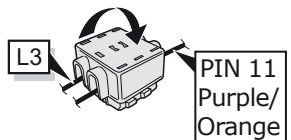
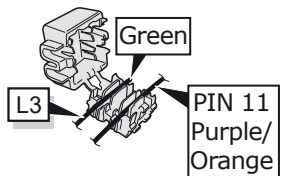

3

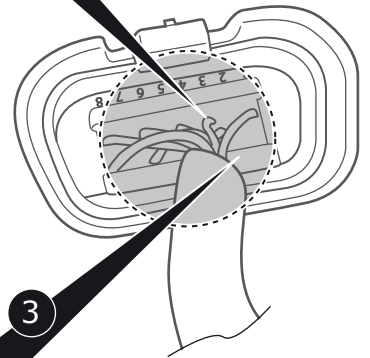

OPTION 4

L3

X

5pole Green

4pole Black

or

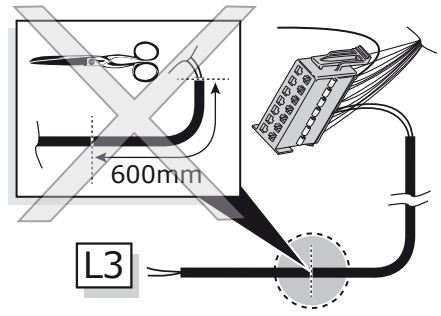

KUGA 2017-

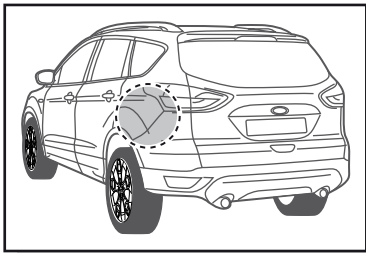
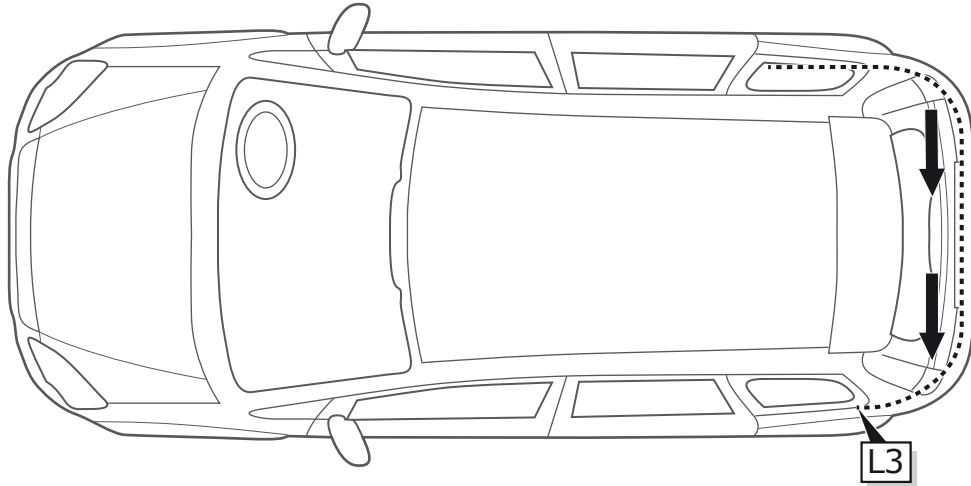

CAN H

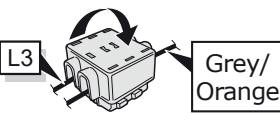
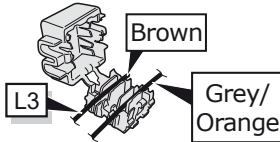

2

CAN L

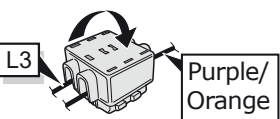
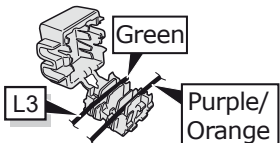

3

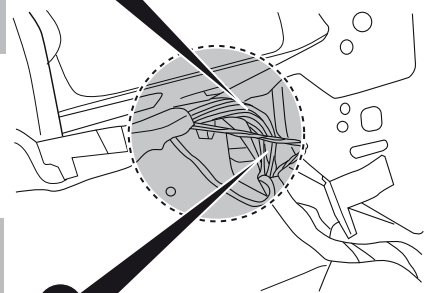
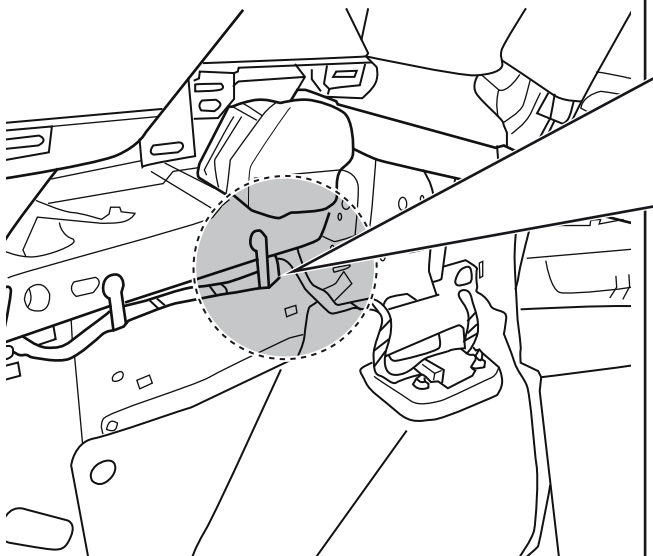

INFO

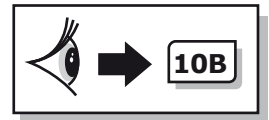
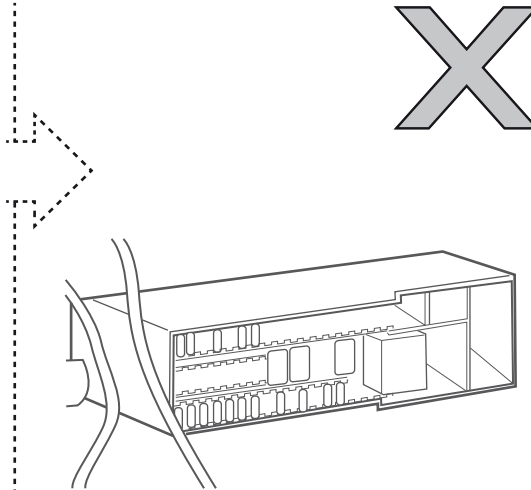
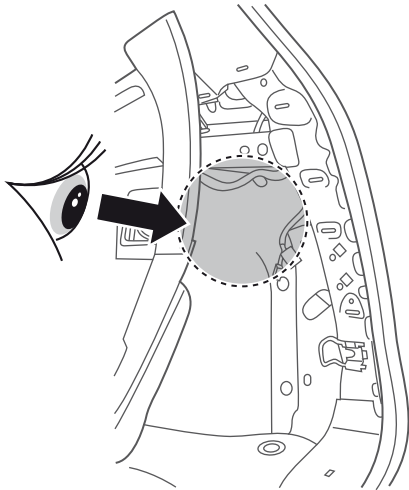
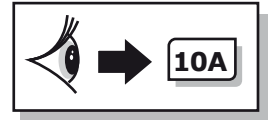
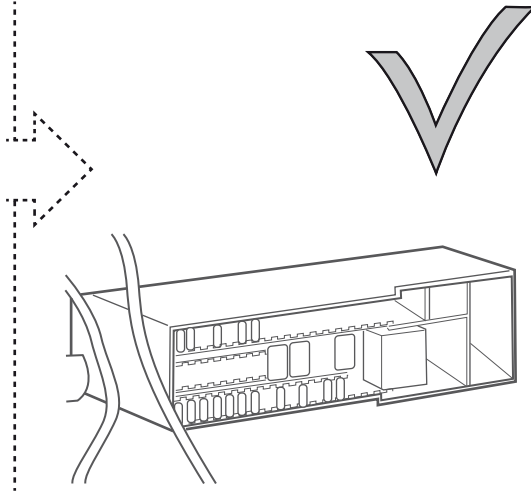
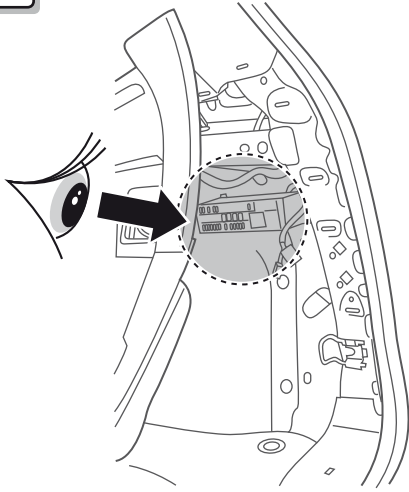

10A

OPTION 1

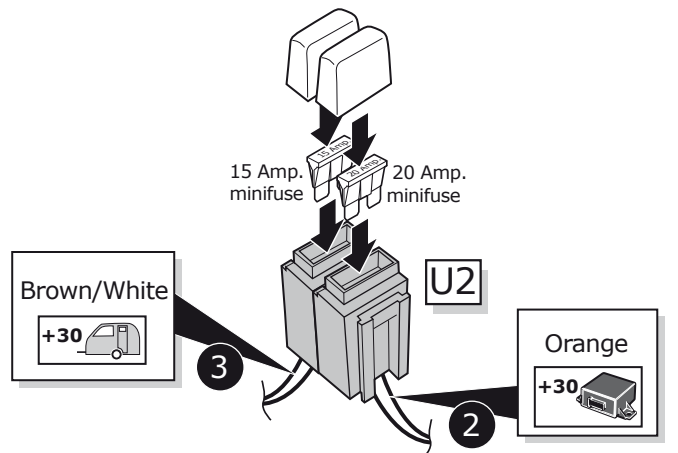
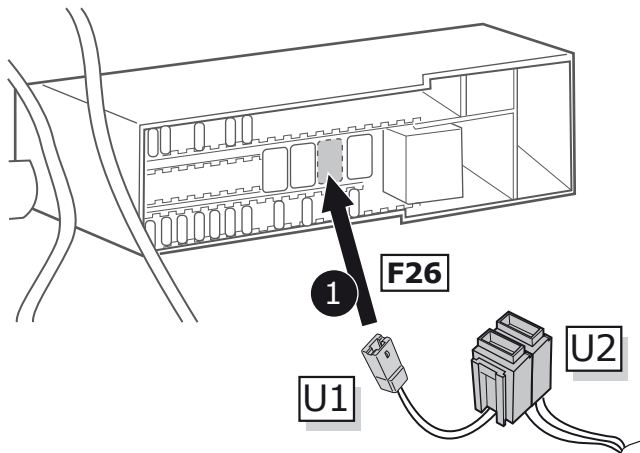
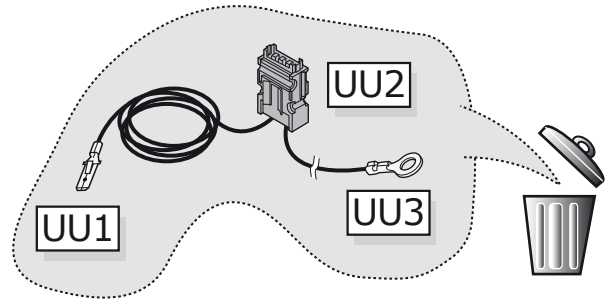
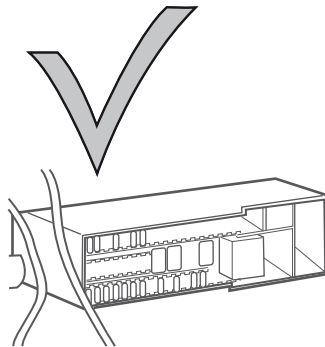
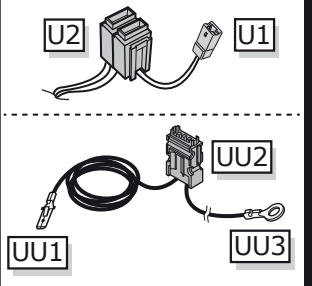

OPTION 2

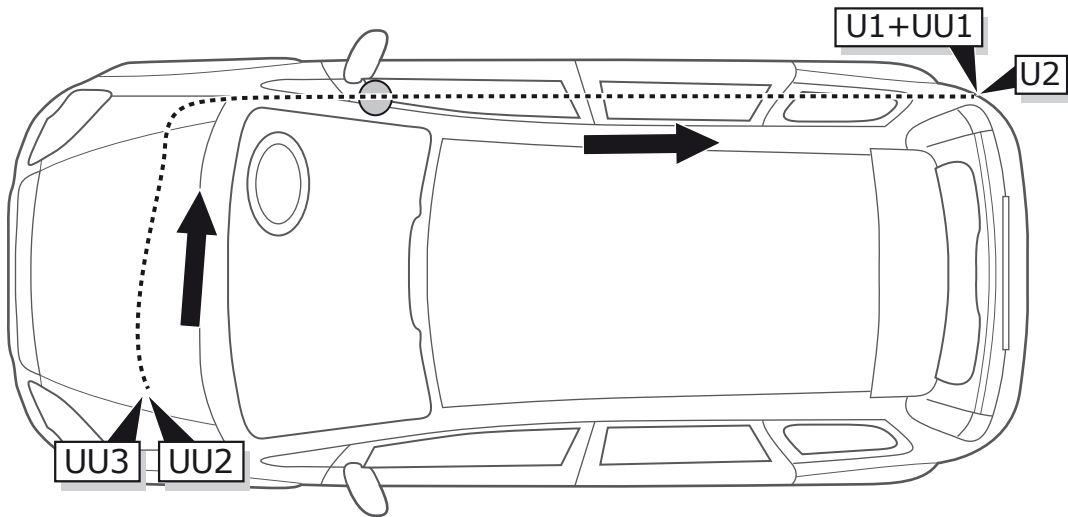
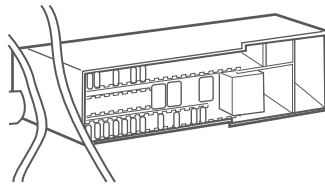
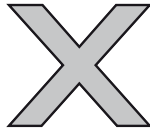
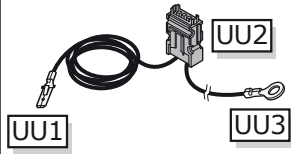
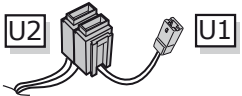

1

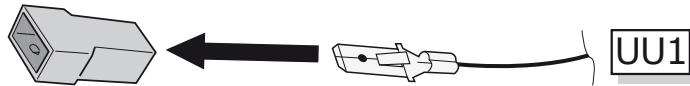

2

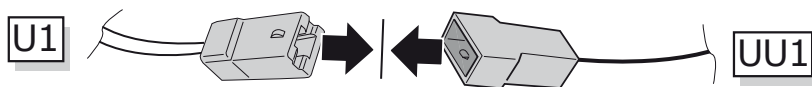

3

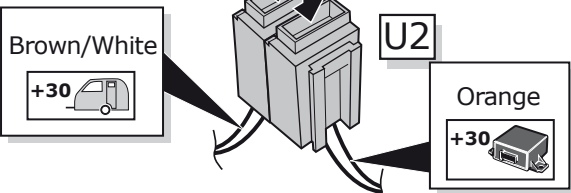
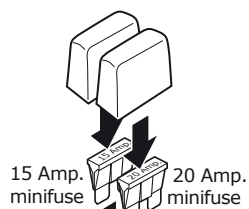

4

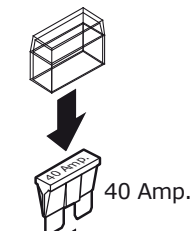

5

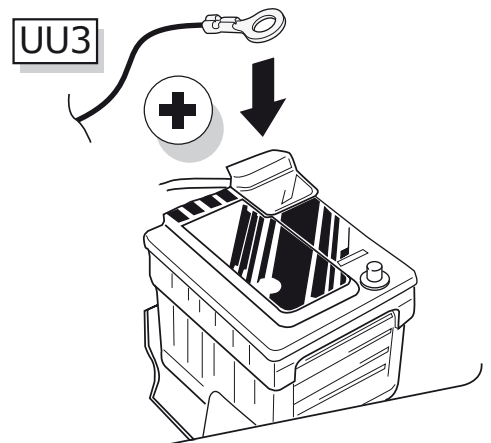

6

11

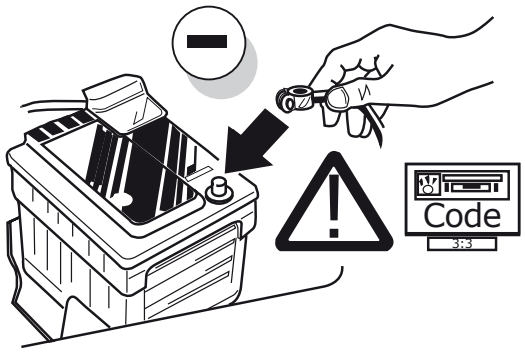

12

Option 1

Manual PDC

PARK DISTANCE CONTROL

↓

PARK DISTANCE CONTROL

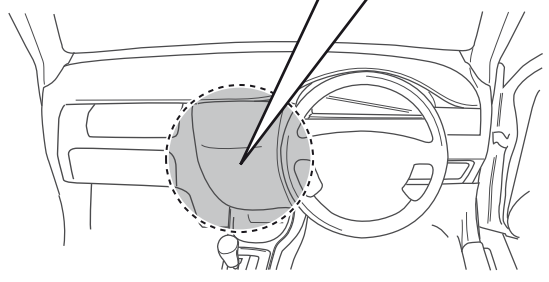
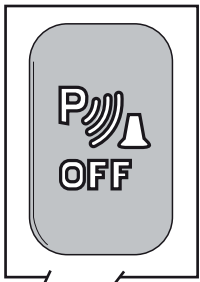

Option 2

Auto PDC

PARK DISTANCE CONTROL

↓

PARK DISTANCE CONTROL

C2

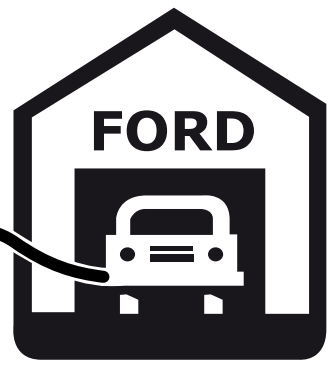
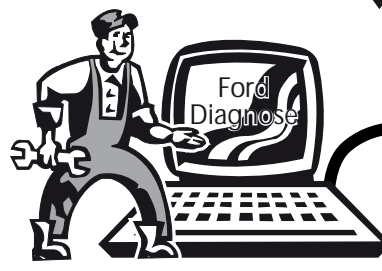

13

Functional test

| | | | | |
|--|--|--|--|---------|
| | | | | 54 STOP |
| | | | | |

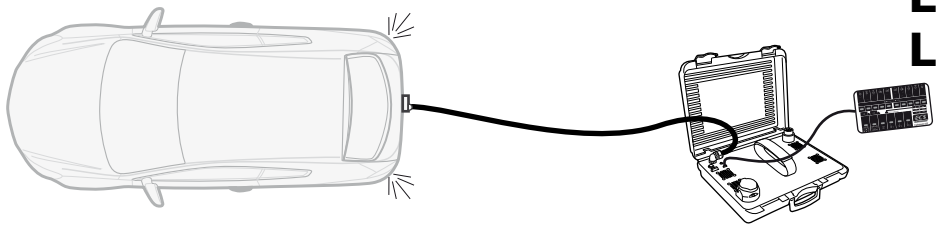
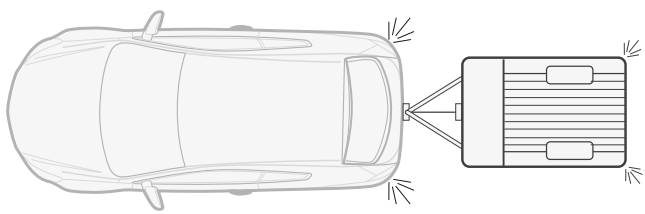

WARNING

LIGHTMATE

ECS part no.
LIGHTMATEII
LIGHTMATEIII

REINSTALL TRIM.

14

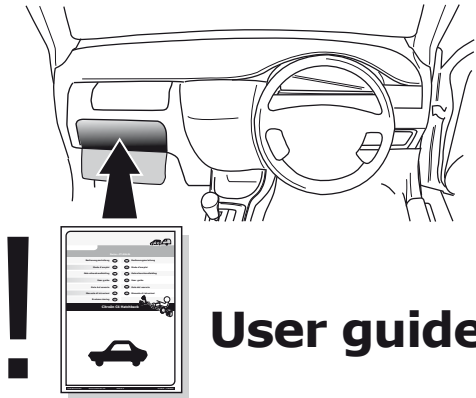

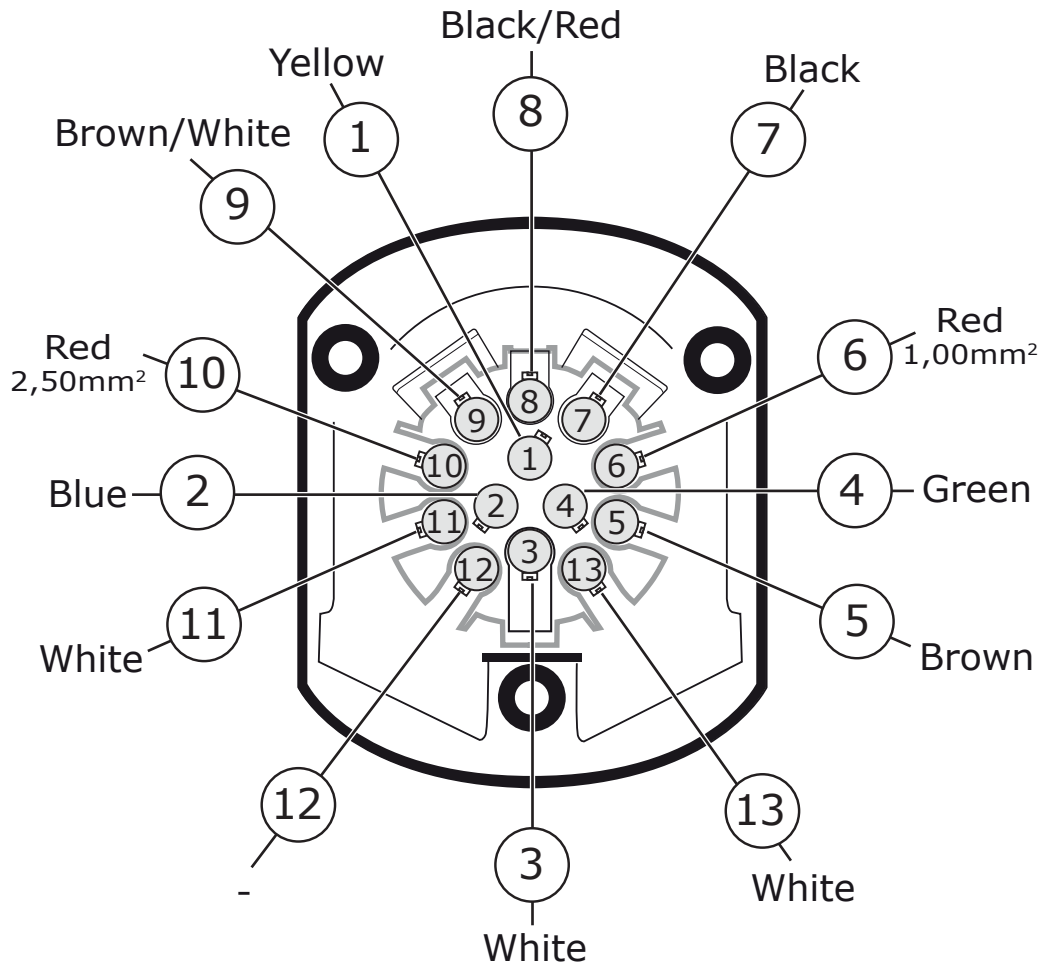
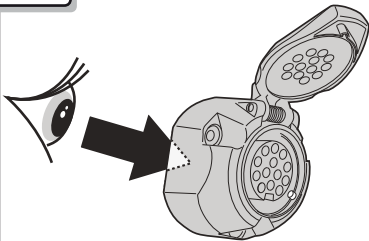

SOCKET CONNECTION

| | | | | | | | | | | | | | |
|---------------|--------|------|-------|-------|--------|-----------------------------|--------|---------------|-----------------|-----------------------------|-------|----|-------|
| DIN/ISO 11446 | | | | | | | | | | | | | |
| | 1/L | 2 | 3/31 | 4/R | 5/58-R | 6/54 | 7/58-L | 8 | 9 | 10 | 11 | 12 | 13 |
| Pmax | 21W | 21W | | 21W | 42W | 3x21W | 42W | 21W | 180W/15Amp | 180W/15Amp | | | |
| Colour | Yellow | Blue | White | Green | Brown | Red 1,00 mm ² | Black | Black/ Red | Brown/ White | Red 2,50 mm ² | White | - | White |